



Fairmans Lane

Brenchley TN12 7JA

Guide Price £514,500



COUNTRY HOMES

Brenchley TN12 7JA

KHP Country Homes are delighted to bring to the market this charming, 3 bed home, situated in the beautiful village of Brenchley.

Offering the perfect rural setting, this lovely home boasts two reception rooms plus a study and downstairs cloakroom. The kitchen and small conservatory overlook the rear garden which offers a large patio and grassed area.

Upstairs are three good size bedrooms, two of which have built-in cupboards and a generous size family bathroom.

Externally, the property is accessed via a driveway which provides plenty of space for parking, in addition to the double garage, there are 15 Solar Panels on the roof which are owned. Situated in a peaceful rural neighbourhood, this property offers a tranquil retreat from the hustle and bustle of everyday life.

Brenchley is a sought-after village location in an area of outstanding natural beauty with easy access to Paddock Wood, Tonbridge & Tunbridge Wells. Local amenities include a newsagents/post office, coffee shop, public house and several sporting clubs plus a dentist and doctors surgery.

Don't miss out on the opportunity to make this charming home your own. Call today to arrange your viewing.

- SOLD BY KHP COUNTRY HOMES
- Rural location
- Sitting room
- Dining area
- Kitchen
- Study
- Downstairs cloakroom
- Bathroom
- Garage plus driveway
- Early viewing highly encouraged



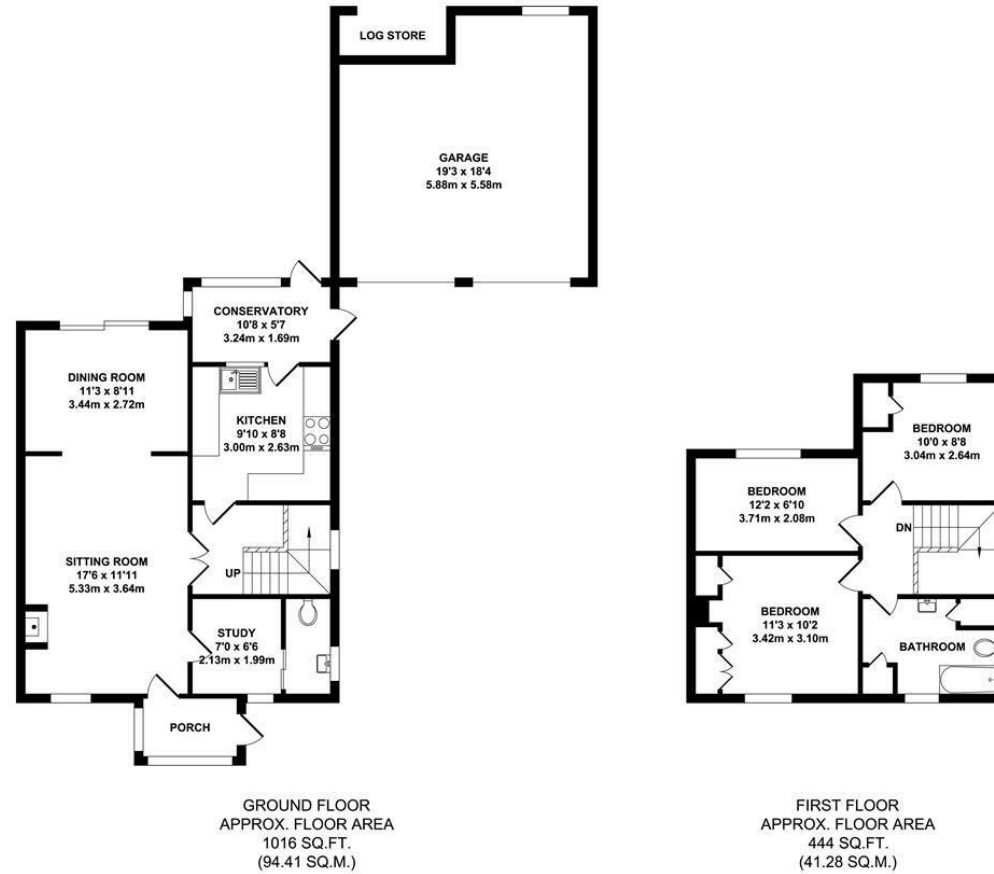

TOTAL APPROX. FLOOR AREA 1461 SQ.FT. (135.69 SQ.M.)

Whilst every attempt has been made to ensure the accuracy of the floor plan contained here, measurements of doors, windows, rooms and any other items are approximate and no responsibility is taken for any error, omission or mis-statement. This plan is for illustrative purposes only and should be used as such by any prospective purchaser. The services, systems and appliances shown have not been tested and no guarantee as to their operability or efficiency can be given.

Zome Media ©2024

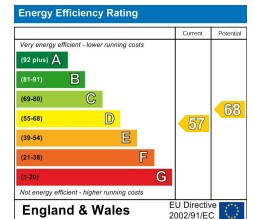

6 Commercial Road, Paddock Wood, Kent, TN12 6EL
 01892 838 080
 countryhomes@khp.me





Location Map

Tenure: Freehold

Council tax band: E

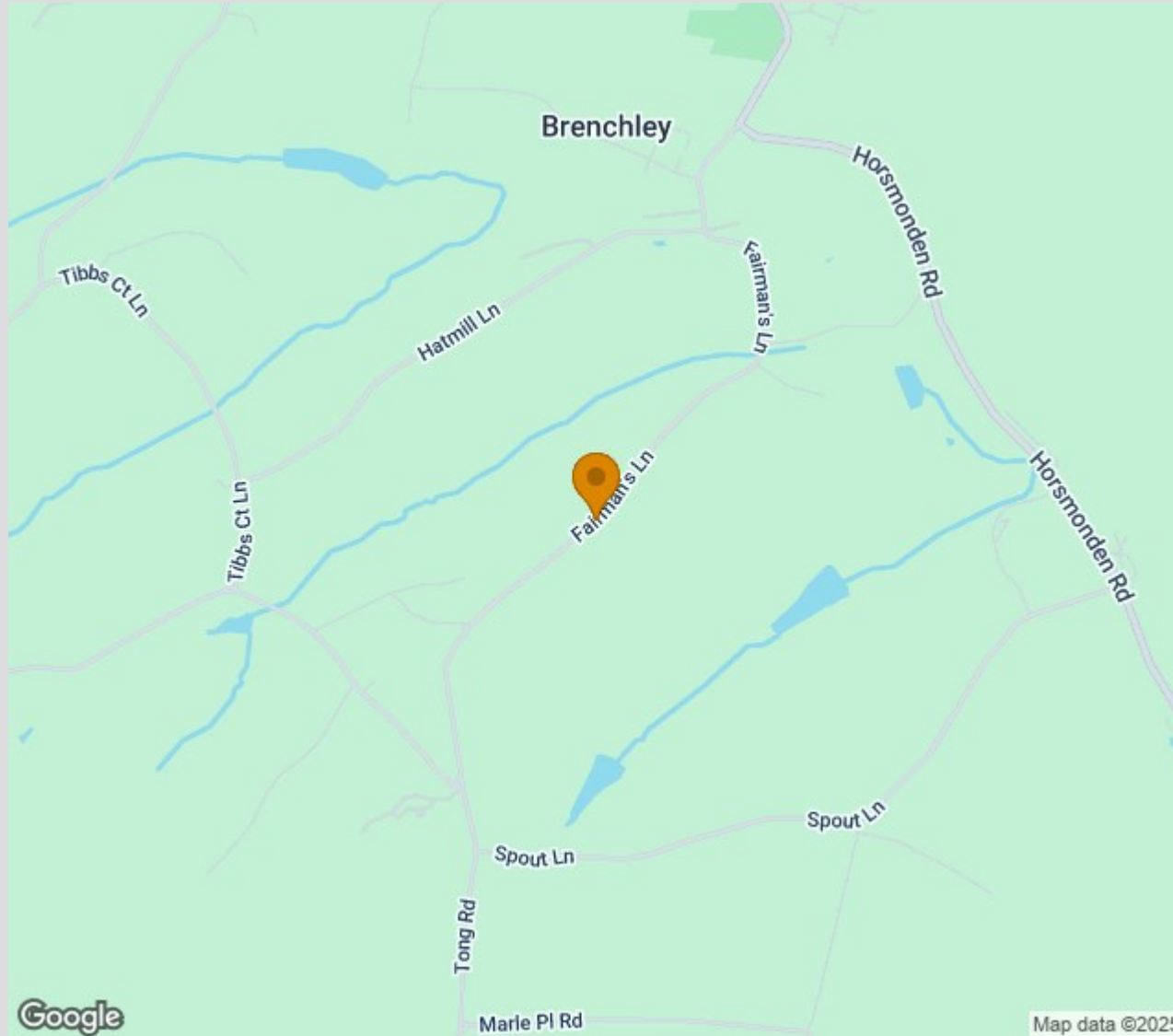

Zoopla.co.uk
Smarter property search



TO VIEW CONTACT:

01892 838 080

countryhomes@khp.me

www.khp.me

